

Palisades II

A customizable and modular zone divider with a mid-century modernism style that gives flexibility to today's more transitory workforce.



Spacestor.

Palisades II

A customizable and modular zone divider with a mid-century modernism style that gives flexibility to today's more transitory workforce.

Components

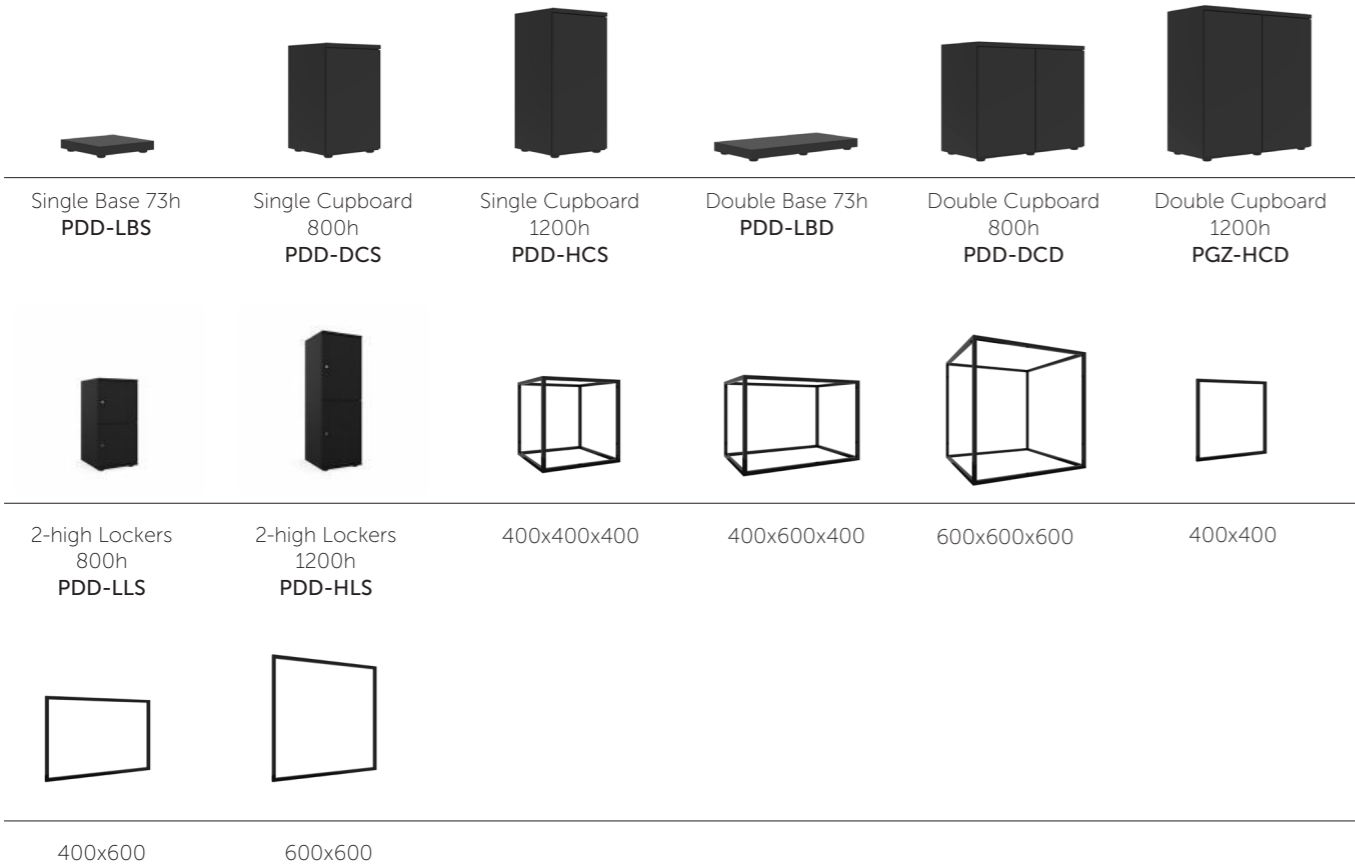

Variations

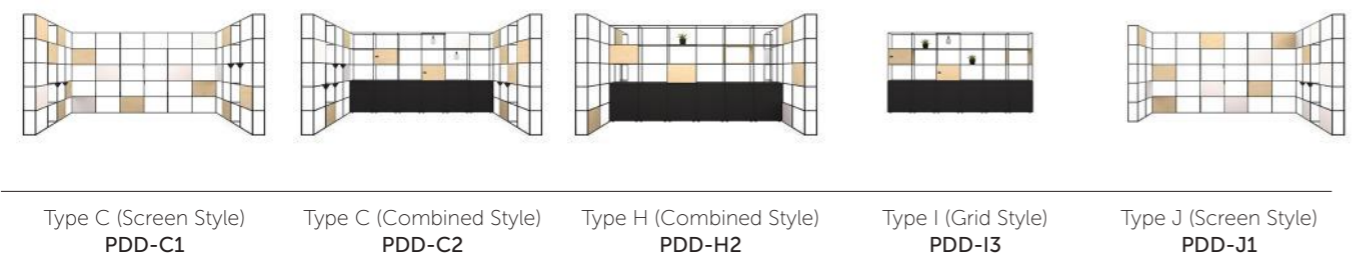

Type J (Combined Style) PDD-J2	Type L (Screen Style) PDD-L1	Type L (Combined Style) PDD-L2	Type L (Grid Style) PDD-L3	Type T (Combined Style) PDD-T2
-----------------------------------	---------------------------------	-----------------------------------	-------------------------------	-----------------------------------

Accessories

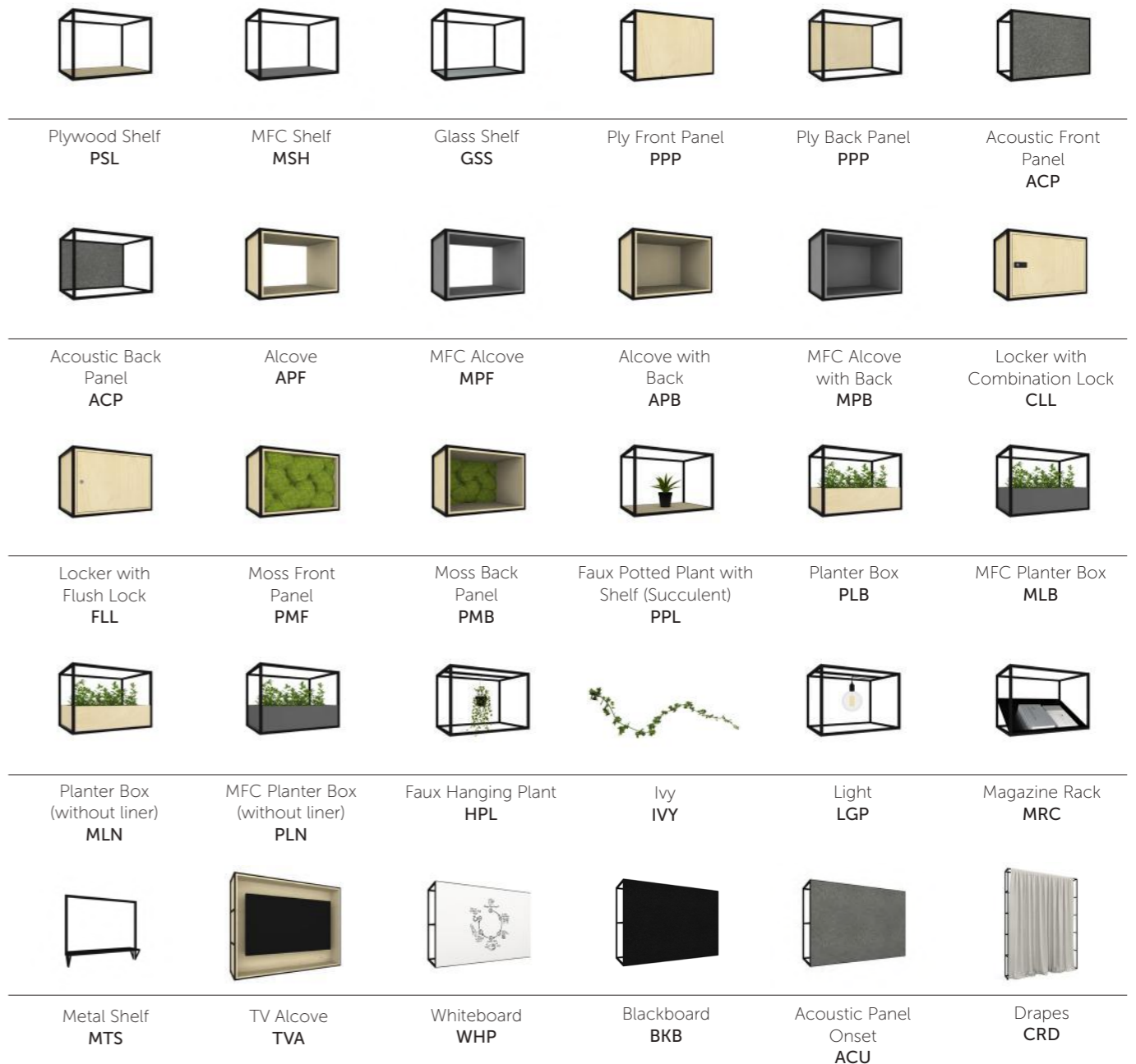



Sheer Curtain
CRS

Finishes

MFC clad finishes

- **Spray Lacquer RAL Classic**
- **MFC 1:** Platinum White, Light Grey, Taupe Grey, Stone Grey, Dakar Grey, Dust Grey, Onyx Grey, Graphite Grey, Black
- **MFC 2:** Premium White, Light Lakeland Acacia, Natural Davos Oak, Natural Maple, Light Sorano Oak, Ellmau Beech, Tobacco Pacific Walnut
- **MFC 3:** Sky Blue, Smoke Blue, Denim Blue, Atoll Blue, Sea Blue, Petrol, Fjord Green, Emerald, Forest Green, Pink, Lipstick, Red, Jaffa Orange, Brilliant Yellow, White Gladstone Oak, Jerusalem Pine, Natural Halifax Oak, Premium White, Black
- **MFC 3:** Swisskrono Collection
- **MFC 4:** Perfectsense Collection
- **Laminates 1:** Polyrey Collection
- **Laminates 2:** Formica Collection
- **Laminates 3:** Fenix Collection
- **Veneers 1:** White American Oak, Steamed Beech, Ash, American Cherry
- **Veneers 2:** Maple, American Walnut
- **Lacquered Plywood**

Grid options

- **Group 1:** Black
- **Group 2:** Signal White, Stone Grey, Beige Grey, Traffic Grey, Olive Green, Pale Green, Green Blue, Cobalt Blue, Purple Red, Beige Red, Red Orange

Colours

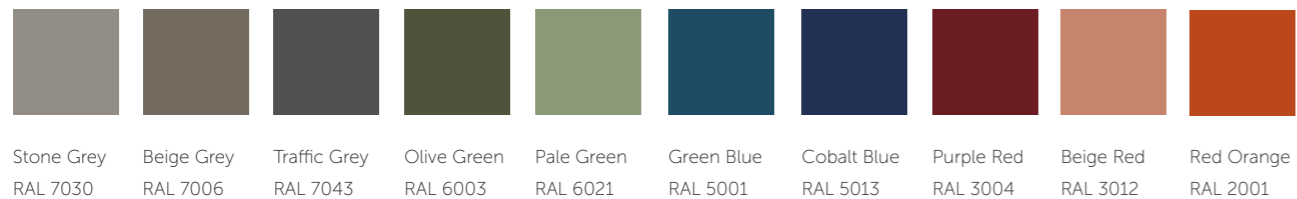

Curtain options

Sheer

- **Group 4:** Kvadrat Air 4
- **Group 5:** Kvadrat Maya, Kvadrat Daybreak

Drapes

- **Group 4:** Kvadrat Haze
- **Group 5:** Kvadrat Mi Casa, Kvadrat Time 300, Kvadrat Casa

Upholstery finishes

- **Group 2:** Camira Main Line Flax, Camira Main Line Plus, Camira Vita, Kvadrat Umami 2, Kvadrat Umami 3
- **Group 3:** Camira Armadillo, Camira Blazer, Camira Marvel, Camira Synergy, Camira Zap, Kvadrat Atlas, Kvadrat Clara 2, Kvadrat Melange Nap, Kvadrat Remix 3,
- **Group 4:** Kvadrat Canvas 2, Kvadrat Divina MD, Kvadrat Fjord, Kvadrat Hallingdal 65, Kvadrat Hero, Kvadrat Steelcut 3, Steelcut Trio 3

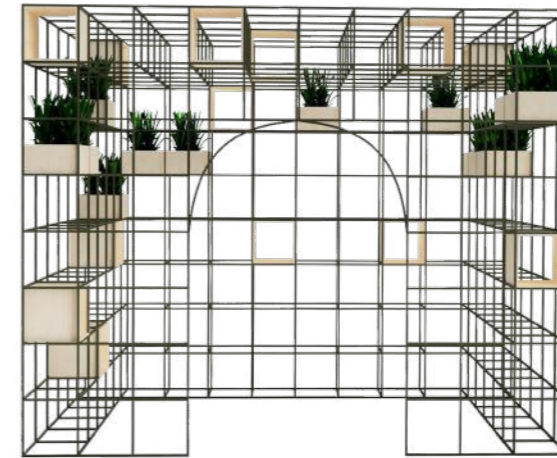

Olive Green
RAL 6003



Purple Red
RAL 3004

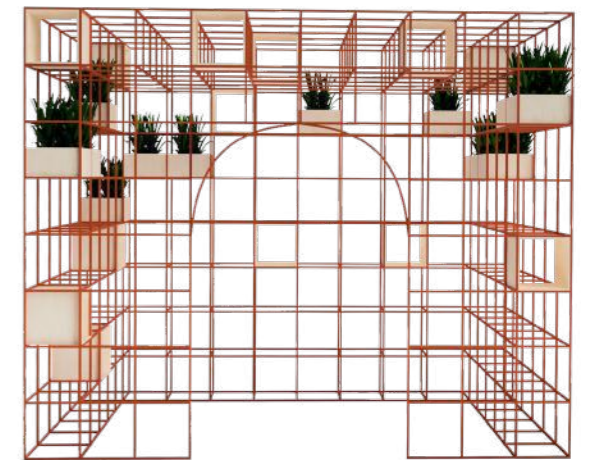

Beige Red
RAL 3004



Green Blue
RAL 5001

Example Configurations



Courtyard



Locker Wall & Collaboration Zone



Dual Collaboration Space with Sheer Curtains

Dimensions (mm)

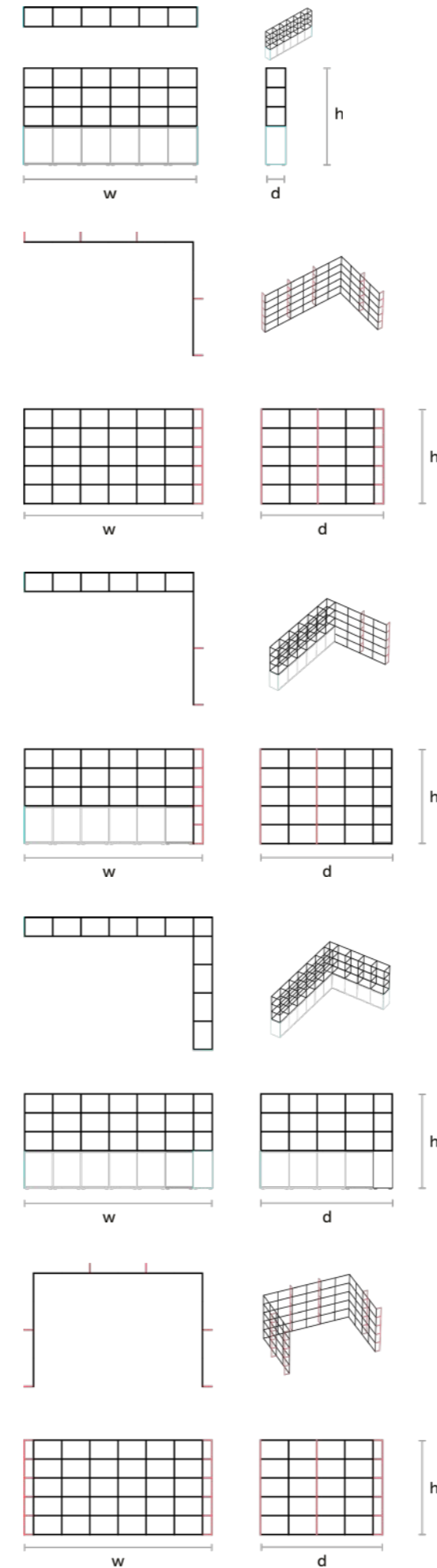

X = number of modules wide, Y = number of modules deep,
Z = number of modules high in the middle run

Type I (Grid Style)

Module Size	Base Height	Overall Width	Overall Depth	Overall Height
400x400x400	0/73/800/1200	$400 * X + 36$	416	$400 * Z + \text{BaseHeight} + 20$
600x400x400	0/73/800/1200	$600 * X + 36$	416	$400 * Z + \text{BaseHeight} + 20$
600x600x600	0/73/800/1200	$600 * X + 36$	616	$600 * Z + \text{BaseHeight} + 20$

Type L (Screen Style)

Module Size	Base Height	Overall Width	Overall Depth	Overall Height
400x400x400	0	$400 * X + 216$	$400 * Y + 216$	$400 * Z + 20$
600x400x400	0	$600 * X + 216$	$600 * Y + 216$	$400 * Z + 20$
600x600x600	0	$600 * X + 216$	$600 * Y + 216$	$600 * Z + 20$

Type L (Combined Style)

Module Size	Base Height	Overall Width	Overall Depth	Overall Height
400x400x400	0/800/1200	$400 * X + 226$	$400 * Y + 416$	$400 * Z + \text{BaseHeight} + 20$
600x400x400	0/800/1200	$600 * X + 226$	$600 * Y + 616$	$400 * Z + \text{BaseHeight} + 20$
600x600x600	0/1200	$600 * X + 226$	$600 * Y + 616$	$600 * Z + \text{BaseHeight} + 20$

Type L (Grid Style)

Module Size	Base Height	Overall Width	Overall Depth	Overall Height
400x400x400	0/73/800/1200	$400 * X + 426$	$400 * Y + 426$	$400 * Z + \text{BaseHeight} + 20$
600x400x400	0/73/800/1200	$600 * X + 426$	$600 * Y + 426$	$400 * Z + \text{BaseHeight} + 20$
600x600x600	0/73/800/1200	$600 * X + 626$	$600 * Y + 626$	$600 * Z + \text{BaseHeight} + 20$

Type C (Screen Style)

Module Size	Base Height	Overall Width	Overall Depth	Overall Height
400x400x400	0	$400 * X + 416$	$400 * Y + 216$	$400 * Z + 20$
600x400x400	0	$600 * X + 416$	$600 * Y + 216$	$400 * Z + 20$
600x600x600	0	$600 * X + 416$	$600 * Y + 216$	$600 * Z + 20$

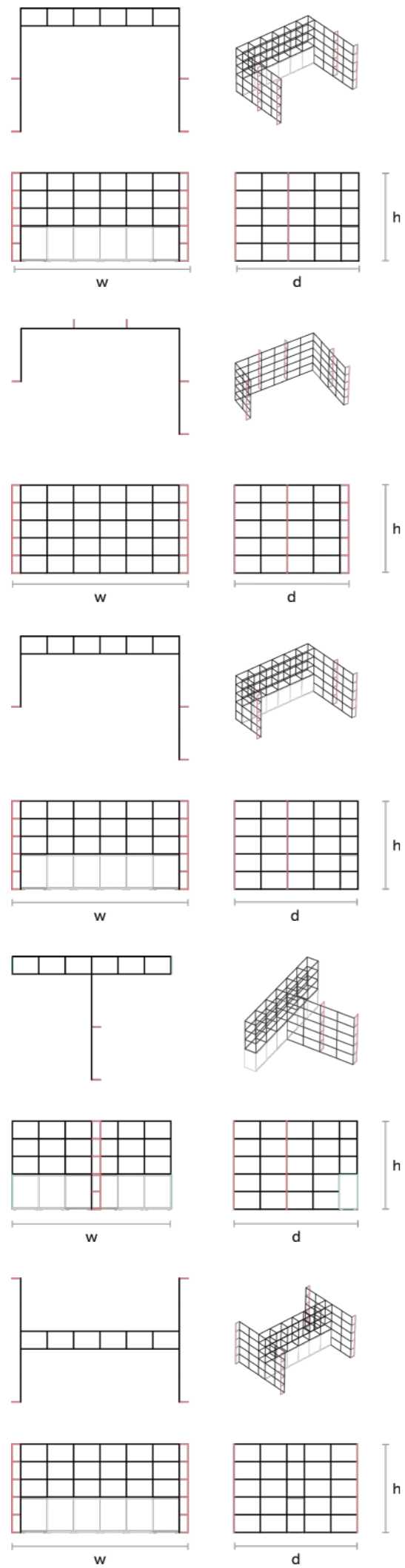

Type C (Combined Style)

Module Size	Base Height	Overall Width	Overall Depth	Overall Height
400x400x400	0/800/1200	$400 * X + 416$	$400 * Y + 416$	$400 * Z + \text{BaseHeight} + 20$
600x400x400	0/800/1200	$600 * X + 416$	$600 * Y + 416$	$400 * Z + \text{BaseHeight} + 20$
600x600x600	0/1200	$600 * X + 416$	$600 * Y + 616$	$600 * Z + \text{BaseHeight} + 20$

Type J (Screen Style)

Module Size	Base Height	Overall Width	Overall Depth	Overall Height
400x400x400	0	$400 * X + 416$	$400 * Y + 216$	$400 * Z + 20$
600x400x400	0	$600 * X + 416$	$600 * Y + 216$	$400 * Z + 20$
600x600x600	0	$600 * X + 416$	$600 * Y + 216$	$600 * Z + 20$

Type J (Combined Style)

Module Size	Base Height	Overall Width	Overall Depth	Overall Height
400x400x400	0/800/1200	$400 * X + 416$	$600 * Y + 416$	$400 * Z + \text{BaseHeight} + 20$
600x400x400	0/800/1200	$600 * X + 416$	$600 * Y + 416$	$400 * Z + \text{BaseHeight} + 20$
600x600x600	0/1200	$600 * X + 416$	$600 * Y + 416$	$600 * Z + \text{BaseHeight} + 20$

Type T (Combined Style)

Module Size	Base Height	Overall Width	Overall Depth	Overall Height
400x400x400	0/800/1200	$400 * X + 36$	$400 * Y + 416$	$400 * Z + \text{BaseHeight} + 20$
600x400x400	0/800/1200	$600 * X + 36$	$600 * Y + 416$	$400 * Z + \text{BaseHeight} + 20$
600x600x600	0/1200	$600 * X + 36$	$600 * Y + 616$	$600 * Z + \text{BaseHeight} + 20$

Type H (Combined Style)

Module Size	Base Height	Overall Width	Overall Depth	Overall Height
400x400x400	0/800/1200	$400 * X + 416$	$400 * Y + 416$	$400 * Z + \text{BaseHeight} + 20$
600x400x400	0/800/1200	$600 * X + 416$	$600 * Y + 416$	$400 * Z + \text{BaseHeight} + 20$
600x600x600	0/1200	$600 * X + 416$	$600 * Y + 616$	$600 * Z + \text{BaseHeight} + 20$

