

Spynamics

Specialist back care
seating for all



Since its introduction in 1999, **Spynamics** has evolved from a single chair into the most comprehensive range of ergonomic seating for all shapes and sizes from 4'10" to 6'10" with a maximum weight guarantee of 30 stones.



Spinal Dynamics

The first **spynamics** chair was designed in a modular fashion ensuring that each of the key areas of the spine received optimal support. Created together with the expertise of osteopath Stephen Green, we have used state-of-the-art material technologies combined with the latest in adjustable seating controls to bring the concept of **spinal dynamics** into the workplace.

The unique feature of **spynamics** is the **triangulation of support** provided by the pelvic module cushion and the two way adjustable lumbar. These combine to provide back comfort that surpasses all other orthopaedic chairs.

The **spynamics** range of chairs promote correct seating posture thereby aiding those with existing back complaints as well as helping others to avoid potential problems.

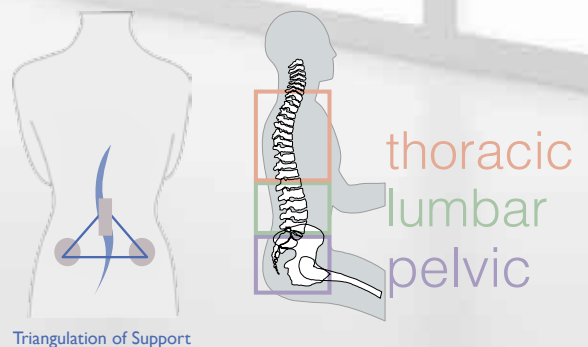

fitting you to your chair

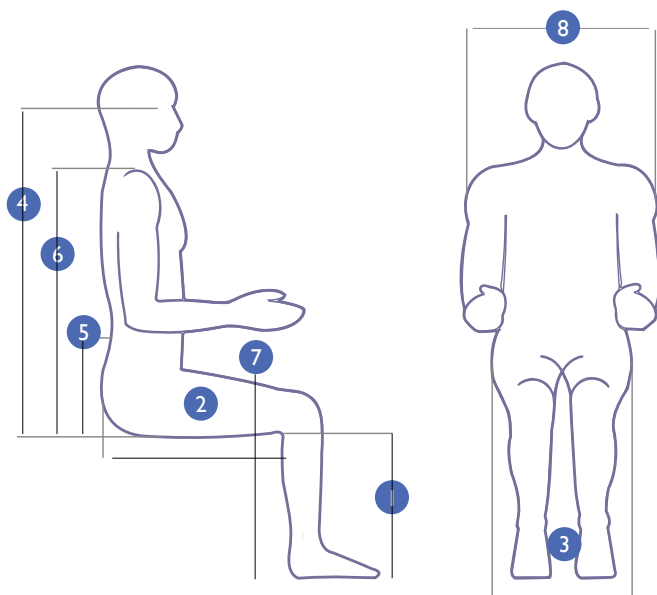

key

- 1 Body seat height, i.e. underside of knee to floor (popliteal to floor height)
- 2 Seat length, i.e. buttocks to underside of knee (buttock to popliteal length)
- 3 Hip width (width of bitrochanter)
- 4 Operator eye height, i.e. buttocks to eye height (sitting eye height or plane of vision to seat) (see note)
- 5 Body armrest height, i.e. buttock to elbow (underside) (elbow to seat height)
- 6 Shoulder height, i.e. buttocks to shoulder (sitting shoulder height) (see note)
- 7 Desk height, as shown
- 8 Armrest separation, i.e. elbow to elbow breadth

note: Dimensions 4 and 6 can be measured either from the seat squab or from the floor

correct sitting

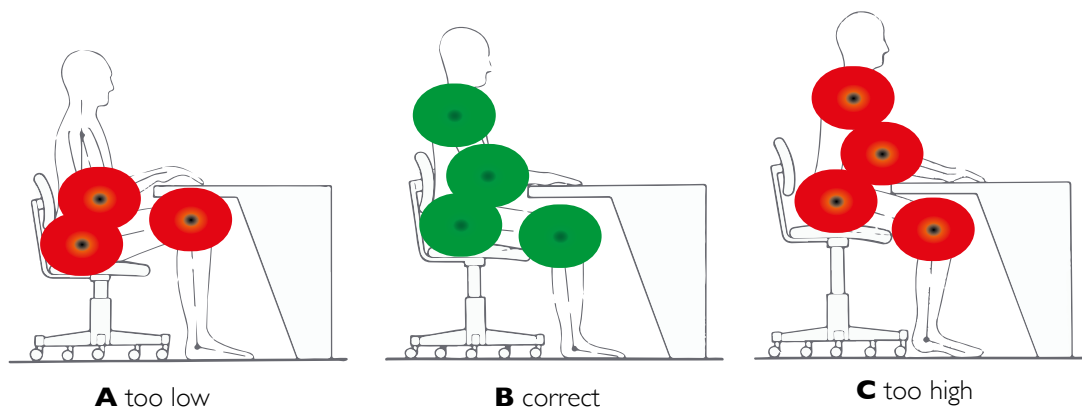

SD7 SD8 Occupational Health Back Care chairs



SD7



SD8



SD8 with Headrest

The Spynamics SD7 medium back and SD8 higher back models carry the endorsement of Occupational Health Practitioners. Working with this sector of the market, we were commissioned to make a chair that did not stand out too much from the crowd, that provided an extensive level of adjustment and comfort at as keen a price as possible. Pelvic (sacral) support is not the key here, but includes a sacral pump all the same. The usual assembly of 3-way lumbar and thoracic (shoulder height) pumps are also included. The infinite adjustable, hard wearing seat and back tilt mechanism caters for the widest population in the office as possible. Added to this, the memory foam seat and back ensures the most cost effective, customizable, therapeutic office chair on the market. Other features and benefits of these models are as follows:

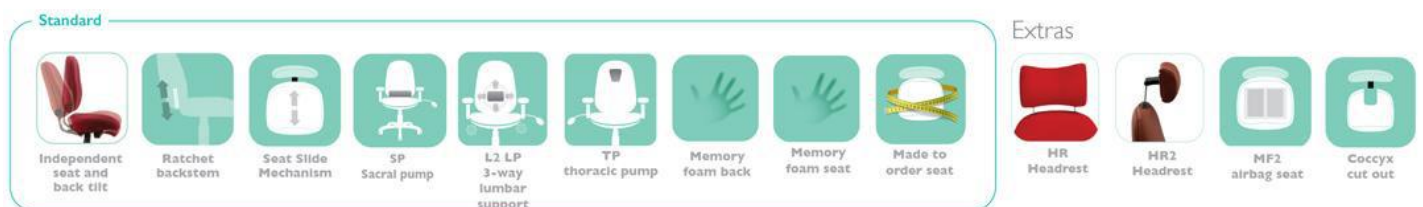

Other ergonomic features include:

- Medium or High back models with sacral pump, 3-way adjustable pump lumbar and pump lumbar
- The 6-way adjustable SPYNAMICS mechanism provides forward tilting seat with independent back rake control, seat depth, and adjustable weight control and ratchet backrest height adjustment
- Memory foam seat and back
- 5-way adjustable arms: one for height, one for forward and back, one for locking swivel and 2 width; other multifunctional and foldaway armrests are also available
- Other seat sizes are available as well as the made to order seat size