

# TREEHOUSE

## sitting four



# TREEHOUSE

## sitting four

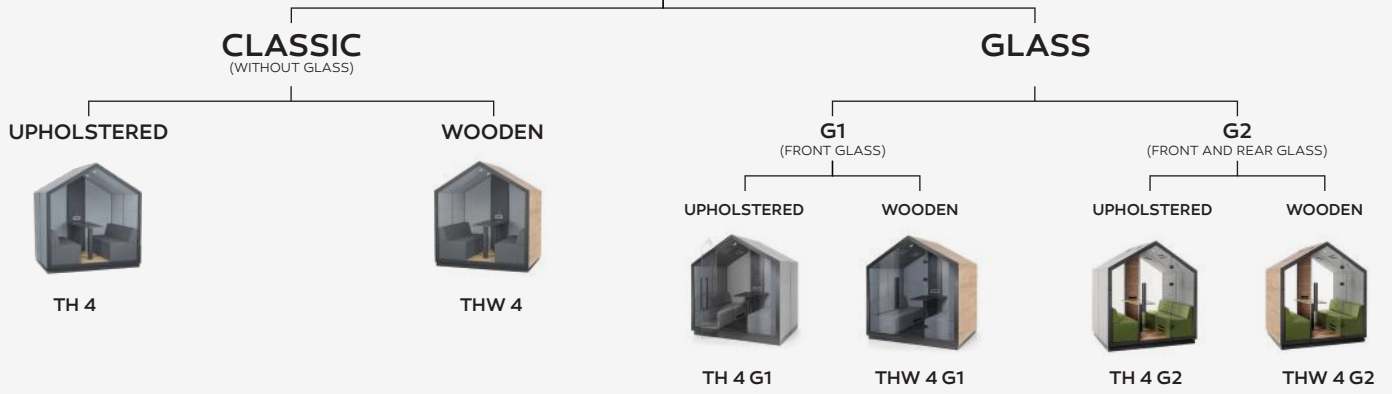

### Table top

- Laminated board

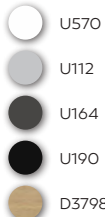

- HPL



- Wooden



### Wooden or sound absorbing upholstered panels

- Wooden



- 15 types of fabrics in a wide range of colours

### Sound absorbing upholstered panels

15 types of fabrics in the wide colour range

### Metal frame, door handle and table leg powder painted (structure)

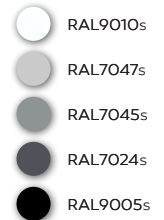

### Multimedia panel

Frame enabling an assembly of a holder for 32-inch TV set

- Laminated board

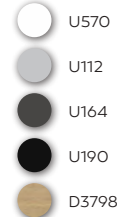

- HPL



- Fabric upholstered inner or outer panels

### Floor

- Wooden



### Acoustic glass

safety according to ČSN EN 12600 standard





LIGHTING 



TWO-STAGE LIGHT REGULATOR 



MEDIA PORT AND POWER SUPPLY 230V   



SMOOTH LIGHT INTENSITY AND VENTILATION REGULATION 



VENTILATION 



VENTILATION 

**CLASSIC** applies to TH CLASSIC (version without glass)

**GLASS** applies to TH GLASS (version with glass)

## CONSTRUCTION

Durable steel frame and carefully selected materials with the high **sound insulation and soundproofing** properties.

## LIGHTING

Efficient, **energy-saving LED** lighting adapted for reading, activated automatically due to a motion sensor. Option of adjusting light intensity with a potentiometer. Adjustable lighting angle **+ -20°**. Color temperature **4300 K**, brightness **390 Lm**.

## ACOUSTICS

Special **acoustic, tempered, laminated glass** with the increased sound insulation properties **R<sub>w</sub>=38 dB** (EN ISO 10140, ISO 717-1).

Due to the solutions used, **confidentiality of conversations is ensured** – persons who are outside will not be able to hear what you are talking about. At the same time, external noise in the booth is significantly reduced.

**Optimal reverberation time** inside in order to conduct conversations in the comfortable manner.

The version that is upholstered outside improves additionally acoustic conditions in the room, **reducing reverberation**.

## VENTILATION

**Efficient ventilation system**, used quiet fans with an air flow of **360 m<sup>3</sup>/h**.

The quantity of air has been adjusted so to ensure optimal user comfort. The system is completely **maintenance free and safe**.

**Ventilation function** – after leaving the booth, the ventilation will work for another 3 minutes to ensure comfort for the subsequent users.

## ELECTRICAL INSTALLATION

**Safe electrical installation**, components made in **12V** standard, with a total power of **24W**. The set includes two cables included: one for lighting and ventilation (length 1 m) and the other for media port (length 1 m) (plug: type E – Poland, France; type F – Germany; type G – United Kingdom).

## MEDIA PORT

**Media port with 230V socket** (type E – Poland, France; type F – Germany; type G – Great Britain), **HDMI and 2x USB**.

# TECHNICAL DATA

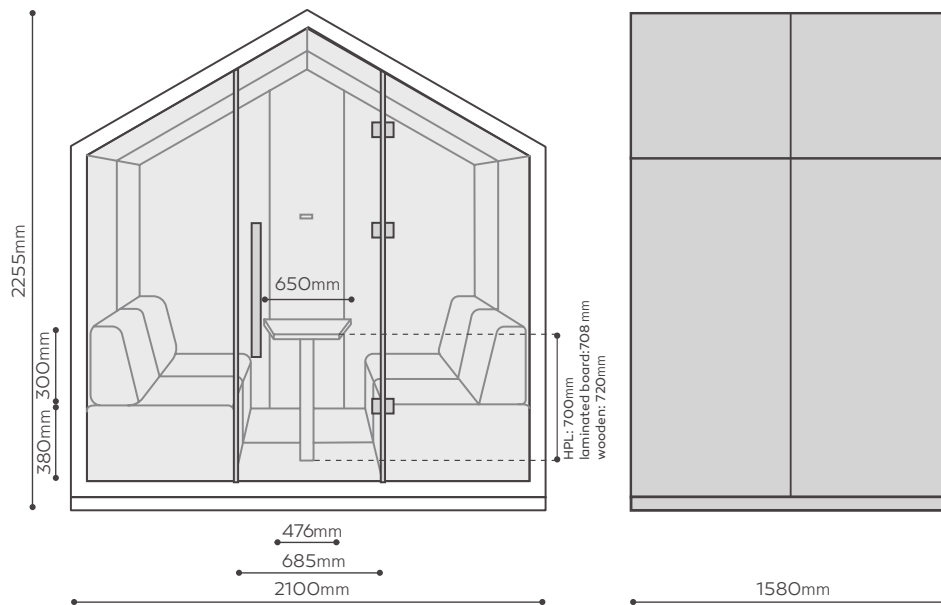

Dimensions are expressed in millimetres. Dimensions are approximate and may vary depending on the selected product configuration. The requirements of the standard are always fulfilled.

The product sheet contains a description of the colour options, variants of the wall, floor and panel finishes, as well as the furnishing components possible to be installed.

# PACKAGE

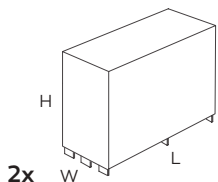

2x

**box made of wood-based panels no. 1 & 2**

H: 1940  
L: 2200  
W: 900

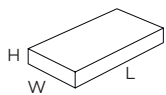

**cardboard packaging no. 3**

H: 320  
L: 1980  
W: 1060

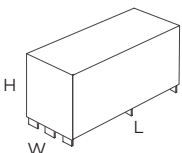

**box made of wood-based panels no. 4**

H: 1340  
L: 2200  
W: 900

	TH 4	THW 4	TH 4 G1	THW 4 G1	TH 4 G2	THW 4 G2
net product weight	480	500	560	580	620	640
gross box weight no. 1	340	350	340	350	340	340
gross box weight no. 2	350	360	350	360	350	350
gross cardboard weight no. 3	80	80	-	-	-	-
gross box weight no. 4	-	-	300	300	360	380